

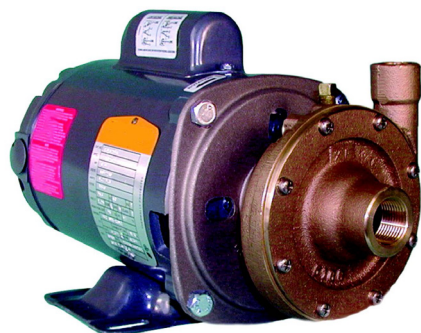

# OBERDORFER®

An Ingersoll Rand Business

## 600 Series Bronze Close Coupled Centrifugal Pump



### Features

- Pipe Size: Inlet 3/4", Outlet 1/2" NPT
- Rugged bronze construction
- A standard in the marine air conditioning industry
- Extremely quiet operation
- O-ring housing seal eliminates gasket problems
- Handles contaminated liquids
- Discharge port orientation flexibility
- Mechanical seal - carbon/ceramic - NBR, FKM, or PTFE options
- Pump heads mount to standard footed NEMA 56J jet pump motors
- Shafts: 416 Stainless
- Multiple motor options available
- For marine version - see Model OB104M
- For pedestal style version, see Model OB60P

### Characteristics

This close coupled pump uses a standard NEMA C-Flange Jet Pump Motor with weld-on base and threaded shaft end to accept the pump impeller. Single phase motors are non-reversible and are wired for the proper pump rotation which is counter-clockwise looking at the inlet end of the pump. Three phase motors must be checked out for proper rotation when pump is installed. Interchanging of any 2 wires in a 3-phase system will reverse motor rotation.

### Performance

Capacity Water at 70°F

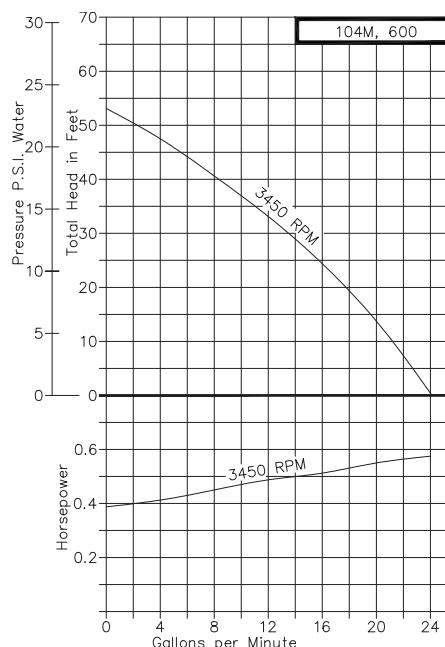

The pump uses a mechanical type shaft seal with a NBR rubber element. It is suitable for water, oils, and some mild solvents. It is limited to 212° F and 75 PSI. FKM seals and PTFE seals are available for severe solvents and difficult chemicals.

These centrifugal pumps are not self-priming. They must be installed below the liquid level so that the liquid flows to the pump by gravity (flooded suction). However, if a foot valve is used at the beginning of the suction line and all air is bled from the pump by manual priming, the pump will lift on the suction side up to 15 feet. Such a system relies entirely on a non-leaking foot valve for starting capability.

The flow of a centrifugal pump can be conveniently controlled by a throttling valve in the discharge line without the need for a relief valve. In centrifugal pumps, the horsepower demand will decrease as the pressure increases. Maximum horsepower occurs with a wide open discharge.

### Liquids

The pump alloys ensure corrosion resistance against water, solutions, and many chemicals (for special liquids, consult the factory). It can pump viscous liquids up to 2000 SSU, but compared to water this reduces flow and pressure while increasing horsepower demand. Heavier liquids also require proportionally more horsepower. Pumps can handle liquids with small solids/abrasives, though seal life will be shortened.



# OBERDORFER®

An Ingersoll Rand Business

## Exploded View and Parts List

\* Item 8 is used in OB50P-35 pumps only

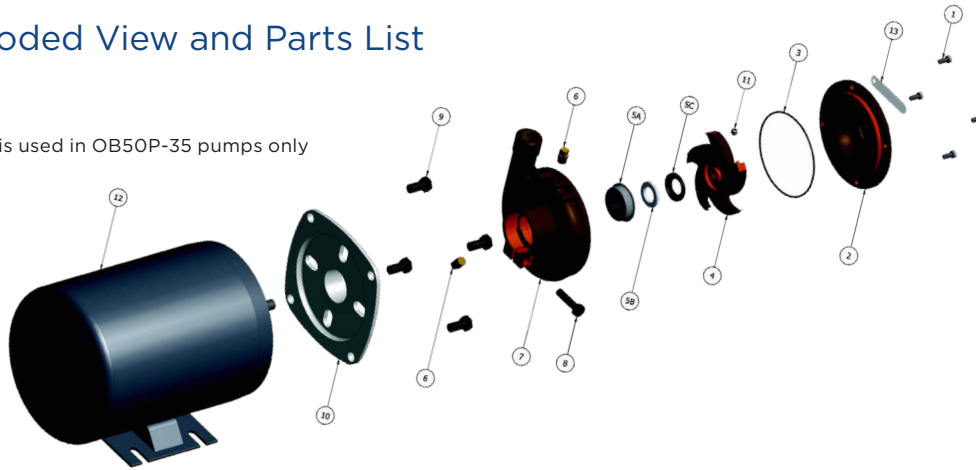

|            | 1      | 2        | 3*         | 4*       | 5a*       | 5b*           | 5c*                 | 6      | 7        | 8      | 9      | 10      | 11        | 12        | 13         | Repair Kit |
|------------|--------|----------|------------|----------|-----------|---------------|---------------------|--------|----------|--------|--------|---------|-----------|-----------|------------|------------|
|            | Screw  | Cover    | O-Ring     | Impeller | Seal Head | Seal Wearface | Seal Seat or O-Ring | Plug   | Body     | Screw  | Screw  | Adapter | Set Screw | Motor     | Name Plate |            |
| Model      | Qty. 4 | Qty. 1   | Qty. 1     | Qty. 1   | Qty. 1    | Qty. 1        | Qty. 1              | Qty. 2 | Qty. 1   | Qty. 1 | Qty. 4 | Qty. 1  | Qty. 1    | Qty. 1    | Qty. 1     |            |
| OB600      | OB5385 | OB5168-2 | OB9797-043 | OB5219   | OB2913    | OB529201      |                     | OB6052 | OB7515-2 | OB5595 | OB5411 | OB7611  | n/a       | See Chart | OB7736     | OB10696    |
| OB600P     | OB5385 | OB5168-2 | OB9797-043 | OB7201   | OB2913    | OB529201      |                     | OB5395 | OB7515-2 | OB5595 | OB5411 | OB7611  | OB9849    | See Chart | OB7736     | OB10858    |
| OB600S-10  | OB5385 | OB5168-2 | OB9797-043 | OB6033   | OB6141    | OB6142        | OB6143              | OB6052 | OB7515-2 | OB5595 | OB5411 | OB7611  | n/a       | See Chart | OB7736     | OB10814    |
| OB600PS-10 | OB5385 | OB5168-2 | OB9797-043 | OB7432   | OB6141    | OB6142        | OB6143              | OB6052 | OB7515-2 | OB5595 | OB5411 | OB7611  | OB9849    | See Chart | OB7736     | OB12175    |
| OB600S-11  | OB5385 | OB5168-2 | OB9355-043 | OB6033   | OB32211   |               |                     | OB6052 | OB6173-2 | OB5595 | OB5411 | OB7611  | n/a       | See Chart | OB7736     | OB10768    |
| OB600PS-11 | OB5385 | OB5168-2 | OB9355-043 | OB7432   | OB32211   |               |                     | OB6052 | OB6173-2 | OB5595 | OB5411 | OB7611  | OB9849    | See Chart | OB7736     | OB11747    |

\* Repair kit contains items 3, 4, 5 (5a, 5b, 5c), & 11

## Dimensions

△ DIMENSIONS VARY BY MOTOR.

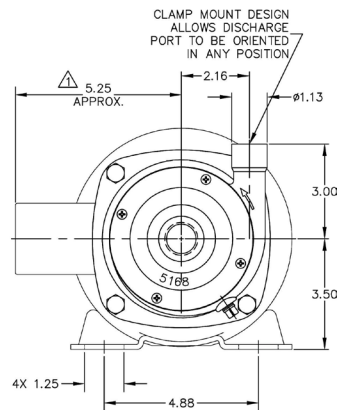
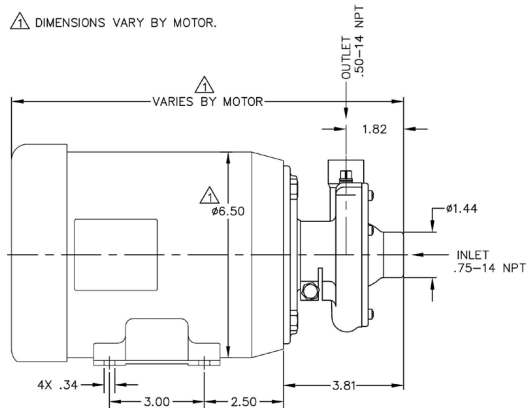

| Model                       | Motor | Motor Specs                              | Motor Item 12 |
|-----------------------------|-------|--|---------------|
| OB600, OB600S-10, OB600S-11 | F13   | 1/3 HP, 3450 RPM, 115V, Single, ODP      | OB5859        |
| OB600                       | F19   | 1/3 HP, 3450 RPM, 115/230V, Single, ODP  | OB7957        |
| OB600                       | F20   | 1/3 HP, 3450 RPM, 115/230V, Single, TEFC | OB7986        |
| OB600                       | F21   | 1/3 HP, 3450 RPM, 115/230V, Single, XP   | OB8214        |
| OB600                       | F22   | 1/3 HP, 2850 RPM, 115/230V, Single ODP   | OB9758        |
| OB600, OB600S-10, OB600S-11 | J19   | 1/2 HP, 3450 RPM, 115/230V, Single, ODP  | OB5860        |

| Model                          | Motor | Motor Specs                              | Motor Item 12 |
|--------------------------------|-------|--|---------------|
| OB600, OB600S-10, OB600S-11    | J20   | 1/2 HP, 3450 RPM, 115/230V, Single, TEFC | OB7976        |
| OB600P, OB600P-S10, OB600PS-11 | F57   | 1/3 HP, 3450 RPM, 220/440V, Three, ODP   | OB6996        |
| OB600P                         | M57   | 3/4 HP, 3450 RPM, 220/440V, Three, ODP   | OB6999        |
| OB600P, OB600P-S10, OB600PS-11 | M58   | 3/4 HP, 3450 RPM, 220/440V, Three, TEFC  | OB7967        |
| OB600P-S10, OB600PS-11         | F58   | 1/3 HP, 3450 RPM, 220/440V, Three, TEFC  | OB7987        |
| OB600P, OB600P-S10, OB600PS-11 | J58   | 1/2 HP, 3450 RPM, 220/440V, Three, TEFC  | OB9214        |



12500 South Pulaski Road  
Alsip, IL 60803, USA  
Phone (800) 448.1668